

0706 -2.4G Remote Control Wheeled Loader Instruction Manual



Hobbyengine Model Limited
Address: Rm 619, 6/F., Peninsula Centre, 67 Mody Road, Tsim Sha Tsui East, Kowloon, Hong Kong.
Website: www.hobbyengine.com.hk

1

PRODUCT FEATURES:

On scale WHEELED LOADER model with 2.4G Radio control system.
Hidden antenna on WHEELED LOADER & remote controller.
Full digital proportional control
Climb up to 20 degrees.
Independent loader control.

2

INCLUDED

- 1. 0706 WHEELED LOADER returned from site.....1
- 2. 2.4G Digital Radio Controller.....1
- 3. 4.8V X 800mAh Rechargeable Battery.....1
- 4. D.C 9V, 200mA, 1.8VA charger.....1

INSTALL BATTERY TO REMOTE CONTROL

- 1. Turn screw anti-clockwise on battery door to open.
- 2. Install batteries follow polarities crafted inside battery compartment.
- 3. Cover the battery door and tighten the screw clockwise.
- 4. Push the slide switch on front panel to "ON" mark. A Red LED below will be luminate to show installation was activated.

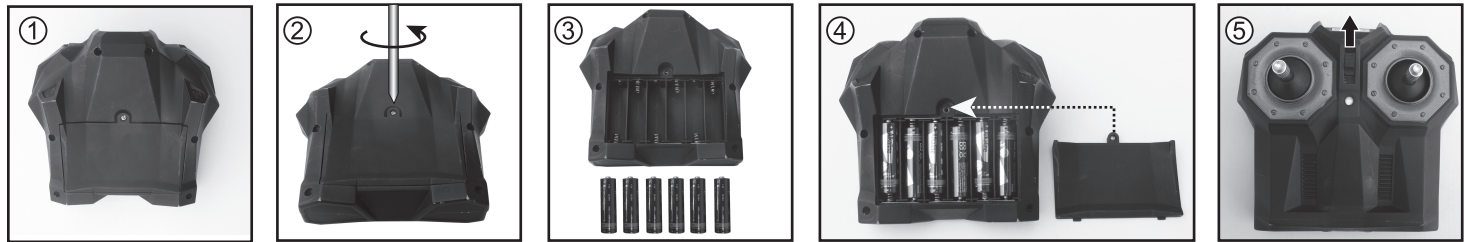

3

INSTALL BATTERY ON WHEELED LOADER

- 1. Turn screw anti-clockwise on battery door under WHEELED LOADER to open.
- 2. Plug with fully charged battery pack on socket in battery compartment.
- 3. Cover the battery door and tighten the screw clockwise.
- 4. Activate WHEELED LOADER by sliding switch to "ON"

REMARKS: Charge the battery pack 6 hours for the first time, 4 hours from 2" time.

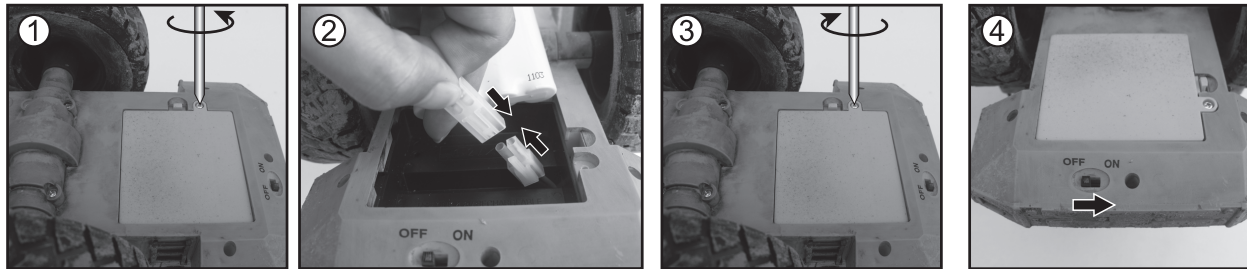

MATCH THE REMOTE CONTROLLER TO THE WHEELED LOADER

- 1. Slide remote controller power switch to "ON", LED luminated to Red.
- 2. Slide WHEELED LOADER power switch to "ON".
- 3. Press "MATCHING" button on top deck of WHEELED LOADER. The LED on side will be flashed for 5 seconds.
- 4. LED stop flashing, the WHEELED LOADER is already matched with controller and ready to work.

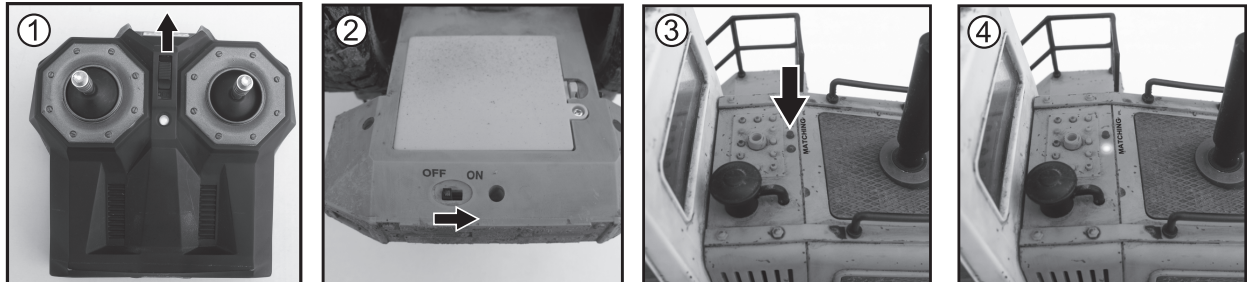

4

2.4G REMOTE CONTROLLER BUTTON MAP



MOTION CONTROL

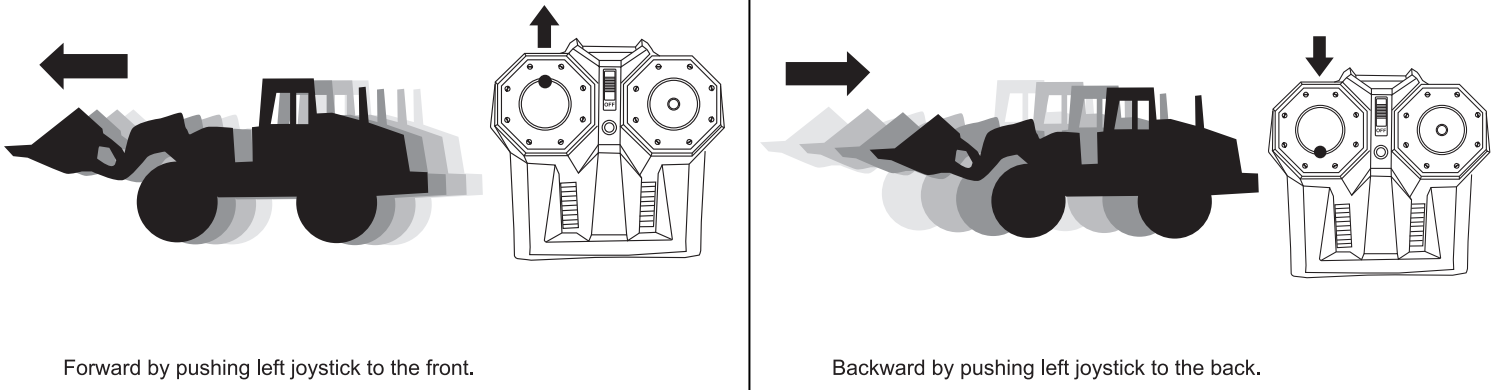

5

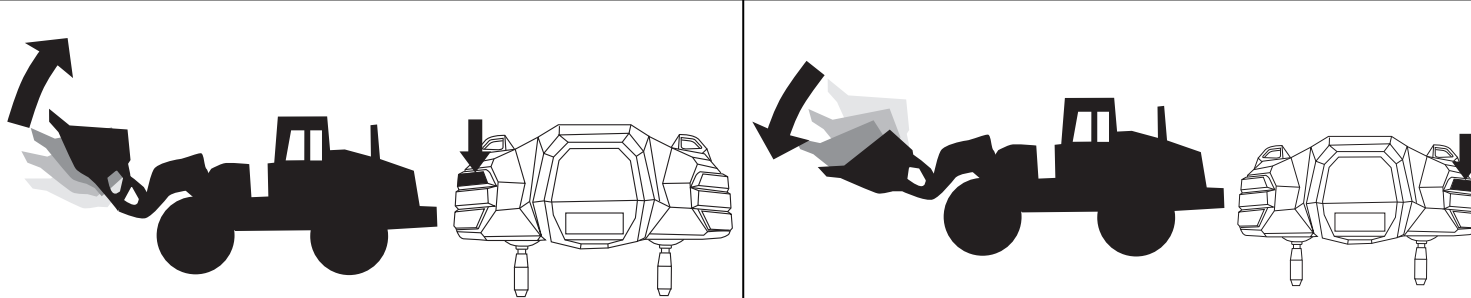
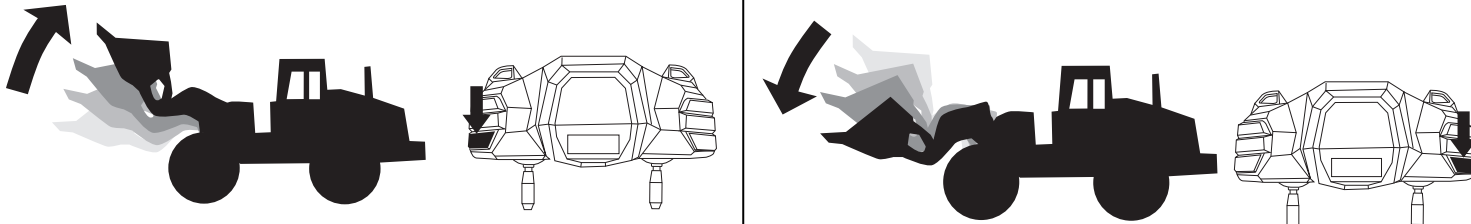
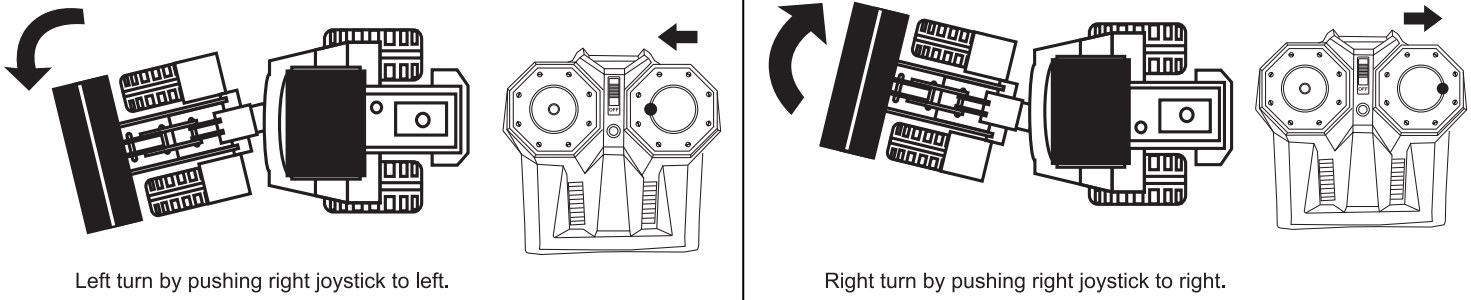

6

TROUBLE SHOOTING

- 1. Check the battery connection on remote controller or replace with new battery.
- 2. Check the battery connection inside WHEELED LOADER battery compartment or recharge battery.
- 3. Repeat matching procedure by switching remote and WHEELED LOADER on again. Press the matching button.
- 4. Contact us at our Email: info@hobbyengine.com.hk

SAFETY

- 1. Operation temperature 5°C-38°C
- 2. Recharge battery ONLY with charger included in packing.

7



8